

Nyloc Insert Nut

Thread Type: Metric - Fine

Thread Direction: Right Hand

Material: Stainless Steel

Class Grade: A2-70 G304

Corrosion Protection Level: Excellent

Standard: DIN 985

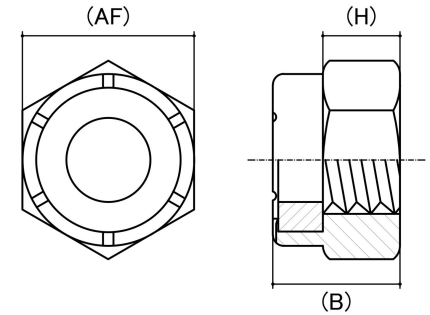

*CAD drawings shown for graphic representation only.**

Size	Thread Pitch (mm)	Thread Type	Overall Nut Height (B) (mm)		Hex Height (H) (mm)	Across Flats (AF) (mm)		Spanner Size (AF) (mm)	sku (qfind)
			Min	Max	Nom	Min	Max		
M8	1.00	Fine	7.64	8.00	5.50	12.73	13.00	13	41NMFS8100
M10	1.00	Fine	9.64	10.00	6.50	16.73	17.00	17	41NMFS10100
M12	1.50	Fine	11.57	12.00	8.00	18.67	19.00	19	41NMFS12150
M14	1.50	Fine	13.30	14.00	9.50	21.67	22.00	22	41NMFS14150
M16	1.50	Fine	15.30	16.00	9.50	23.67	24.00	24	41NMFS16150
M18	1.50	Fine	17.66	18.50	10.50	26.16	27.00	27	41NMFS18150
M20	1.50	Fine	18.67	20.00	14.00	29.16	30.00	30	41NMFS20150
M22	1.50	Fine	20.70	22.00	15.00	31.00	32.00	32	41NMFS22150

Disclaimer:

Dimensional data and technical information was obtained from publically available sources and not acquired through standard agencies. It has been completed and compiled for reference purposes only; where discrepancies are found they are subject to change without notice. Bolt & Nut Australia makes no warranties or representations regarding the accuracy and validity of the compiled information and data. Contact the relevant standard authorities for accurate and detailed information.

* CAD drawings may not reflect diameter, thread length or overall length.

© Bolt & Nut Australia Pty Ltd. All rights reserved.

Version: 18 Mar 2024